



ALDGATE TOWER

OVERVIEW

Aldgate Tower offers private office space customized to fit your company, all on flexible terms.

Large floor to ceiling windows enable impressive views and excellent natural light throughout the building.

Meeting rooms are available to hire on an ad hoc basis and are serviced by the on-site management team.

The space is available by way of licence agreement which allows occupiers the ability to expand at any stage of their term.

AMENITIES

- Meeting Rooms
- Lounge
- Phone Booths
- Bike Storage
- Showers
- Kitchens
- High Speed Broadband



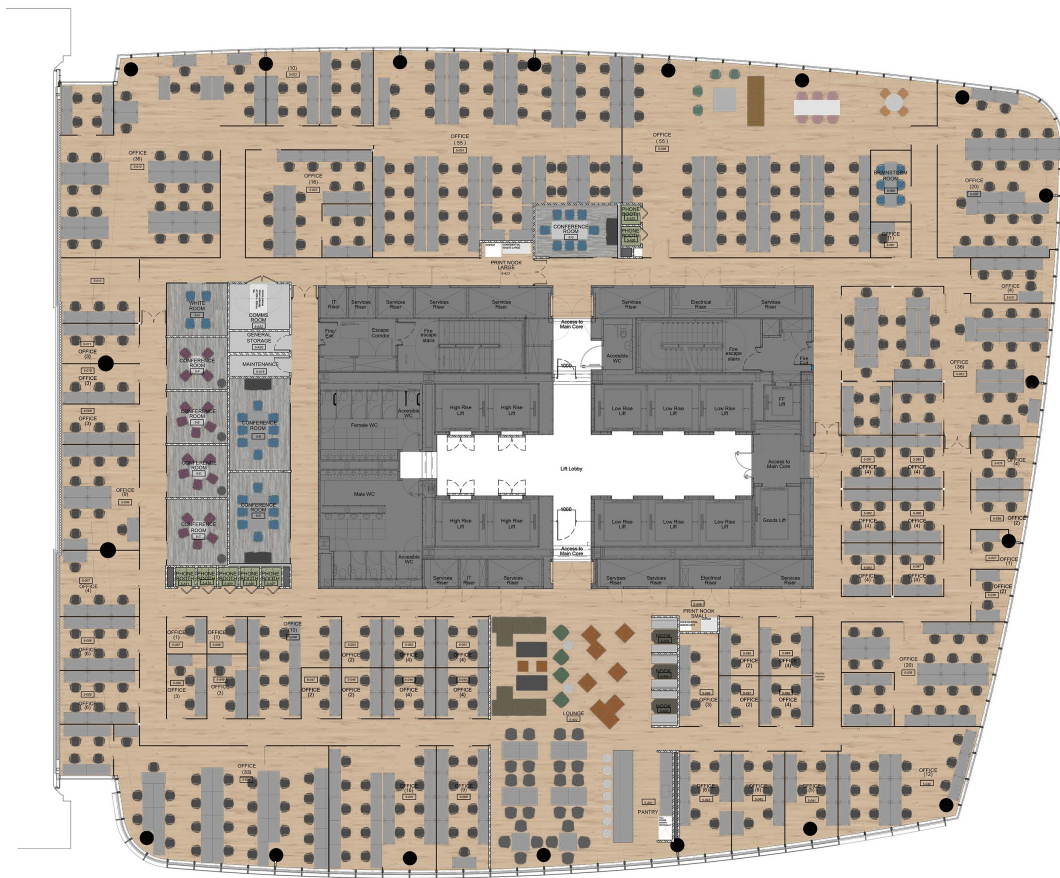

## TERMS

Flexible by arrangement

## SUMMARY

Available Size	50 sq ft to 70,000 sq ft
Price	£600 per desk per month
Business Rates	Included in desk rate
VAT	Elected

## VIEWING & FURTHER INFORMATION

Viewing strictly by prior appointment with the sole agent:

CATHERINE ALEXANDER

catherine@bureauoffice.co.uk

+44 (0)7811 11600

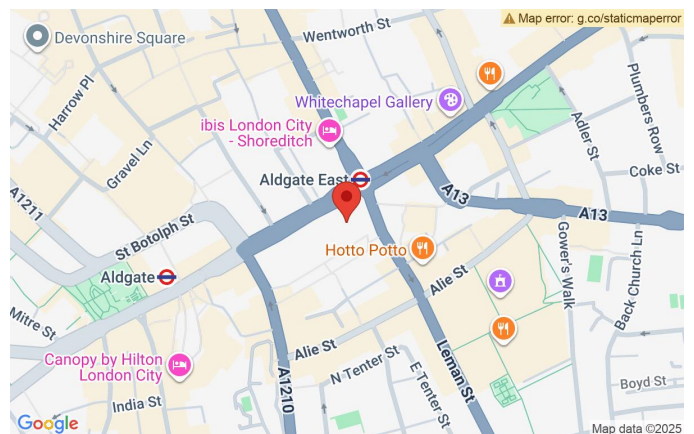

## LOCATION

Aldgate Tower is a stone's throw from Aldgate East station (District and Hammersmith and City lines). Liverpool Street, Aldgate and Whitechapel stations are also within walking distance of the building.

Misrepresentation Act: Bureau Office Limited for themselves and for the vendors or lessors of this property whose agents they are give notice that: (i) the particulars are set out as a general outline only for the guidance of intending purchasers or lessees and do not constitute part of, an offer or a contract, (ii) all descriptions, dimensions, references to condition and necessary permissions for use and occupation, and other details are given in good faith and are believed to be correct but any intending purchasers or tenants should not rely on them as statements of fact but satisfy themselves by inspection or otherwise as to the correctness, (iii) no person in the employment of Bureau Office Limited has the authority to make or give any representation or warranty whatsoever in relation to this property, (iv) all rents and prices are quoted exclusive of VAT.